

**PLANTA GERAL - 01**

Início do trecho  
Est.: 1+114,00  
Lat.: 29°49'25.14"S  
Long.: 51° 7'6.47"O

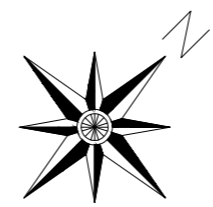

**PLANTA GERAL - 02**

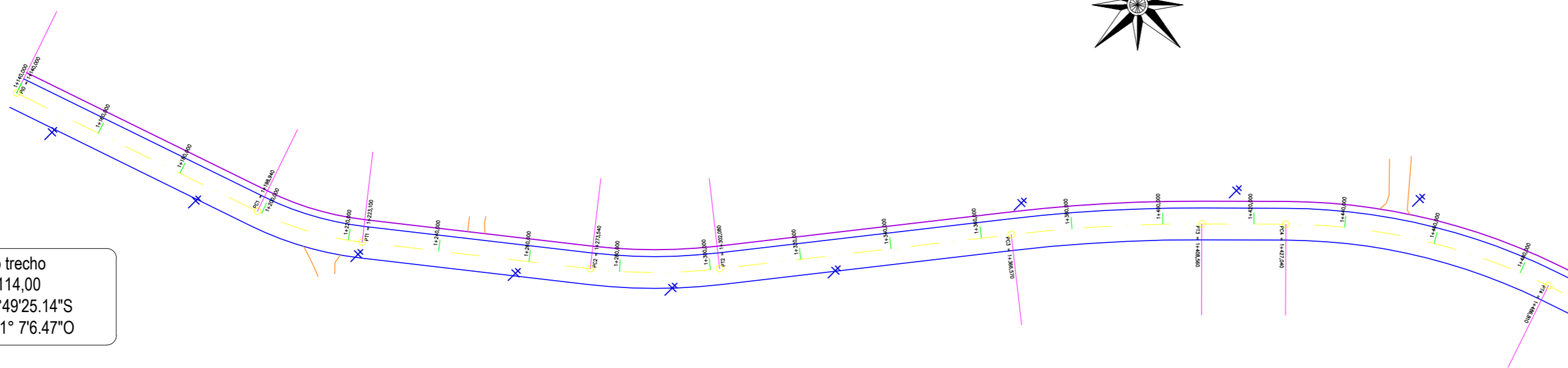
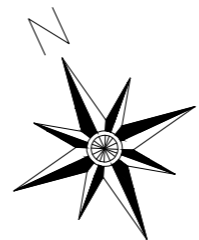
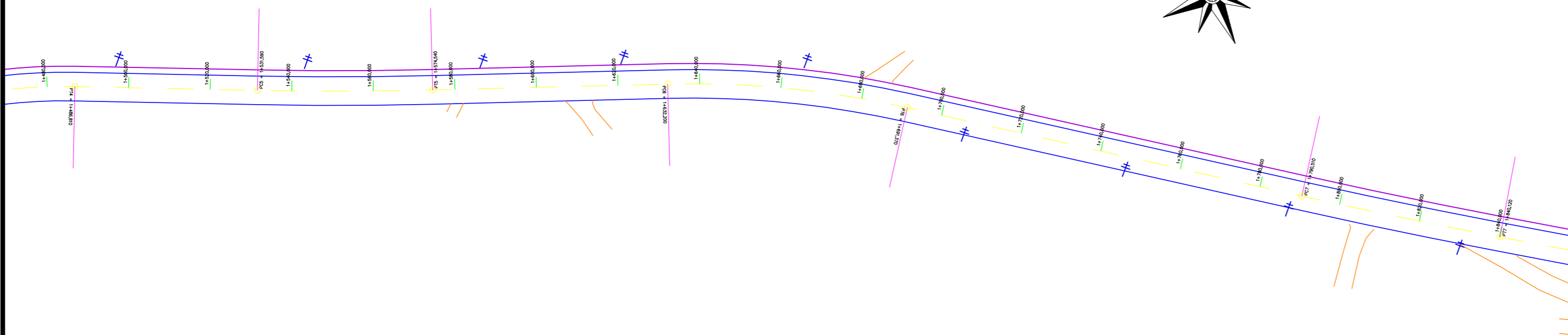

**PLANTA GERAL - 03**

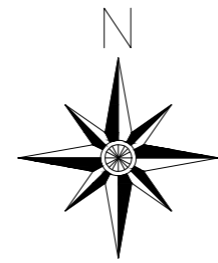
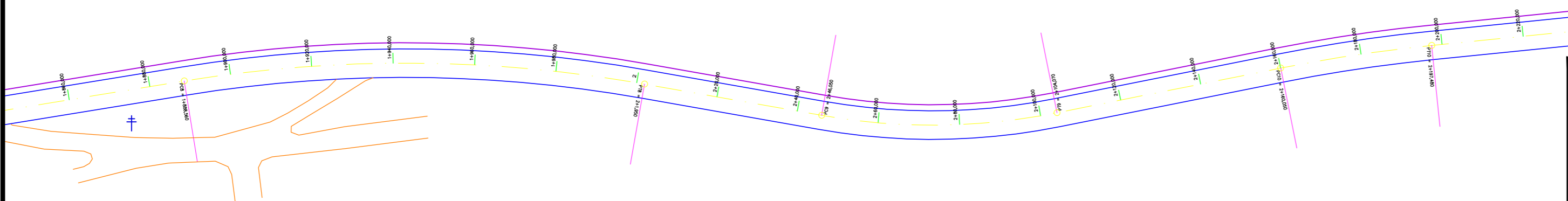

**LEGENDAS**

	ACESSO
	ESTACAS DE 20 EM 20m
	EIXO
	POSTE

PROJETADO	
	BORDO CBUQ
	ACOSTAMENTO
	PC00 = 00+0
	PT00 = 00+0

 <b>ZS Engenharia</b>	TÍTULO: PROJETO GEOMÉTRICO PLANTA GERAL Estaca 1+140 à 4+361,77	PRANCHA: <b>GE-1</b>
	CLIENTE: MUNICÍPIO DE SAPUCAIA DO SUL	OBRA: Projeto de pavimentação asfáltica, drenagem e sinalização
RESPONSÁVEL TÉCNICO: Eng. Civil Zader Schmeigel CREA/RS 143.409	LOCAL: Avenida Justino Camboim Sapucaia do Sul/RS	ESCALA: <b>1:1000</b>
	ÁREA TOTAL: <b>27.287,78m<sup>2</sup></b>	DATA: <b>AGO/2022</b>